



WHEELCHAIR HEADREST











## USER MANUAL

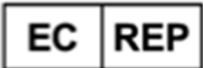

## CONTENTS

	<b>Page</b>
Included in this package	4
Diagrams	4
Transport warning instructions	7
Installation & Occupant Safety Warnings	9
Intended use	9
Risks Identified Disclaimer	9
Product Life expectancy	10
Guarantee	10
Installation instructions	10
Using the headrest	10
Care instructions	10

## SYMBOLS

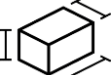
	Identifies products that meet the requirements of Regulation 2017/745 / EU on medical devices		Batch code
	Indicates that a product is a medical device		Catalogue number
	Shows the manufacturer of the medical device		Date of manufacture
	WC20 & ISO7176-19 certified for forward facing use in a motor vehicle		Authorized representative in the European Community
	Product weight (kgs)		Consult instructions for use
	Max User Weight (kgs)		Warnings
	Product Dimensions		

Square

Open curved

Contoured



Pivot-wing



### CODES

	X-SML	SML	LGE
<b>SQUARE - COMPLETE</b>	-	DAHSQSML	DAHSQLGE
<b>OPEN CURVED - COMPLETE</b>	-	DAHOC SML	DAHOC LGE
<b>CONTOURED - COMPLETE</b>	DAHCVXSML	DAHCVSML	DAHCVLGE
<b>PIVOT-WING - COMPLETE</b>	-	DAH PWSML	DAH PWLGE
<b>SQUARE – PAD ONLY</b>		DHPSQSML	DHPSQLGE
<b>OPEN CURVED – PAD ONLY</b>	-	DHPOCSML	DHPOCLGE
<b>CONTOURED – PAD ONLY</b>	DHPCXSML	DHPCSML	DHPCLGE
<b>PIVOT-WING – PAD ONLY</b>	-	DHPWSML	DHPWLGE

### WEIGHTS & DIMENSIONS

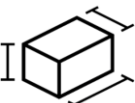
ITEM			
Headrest Pad	1.2	136kg	42cm x 20cm x 6cm
Headrest Bracket (std)	0.65	136kg	45cm x 10cm x 10cm
Headrest Bracket (swing-down)	1.06	136kg	45cm x 10cm x 10cm

## INCLUDED IN THIS PACKAGE



Headrest Pad x 1



Top Arm Assembly x 1



Headrest Vertical Stem x 1

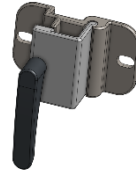

Headrest Mount Assembly x 1

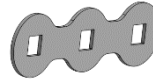

Fixing Plate x 1



M6 x 20mm Coach Bolt x 2



M6 Nyloc Nut x 2



Washer x 2

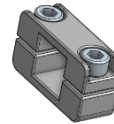

Height Lock Assembly

## DIAGRAMS

Fig 1

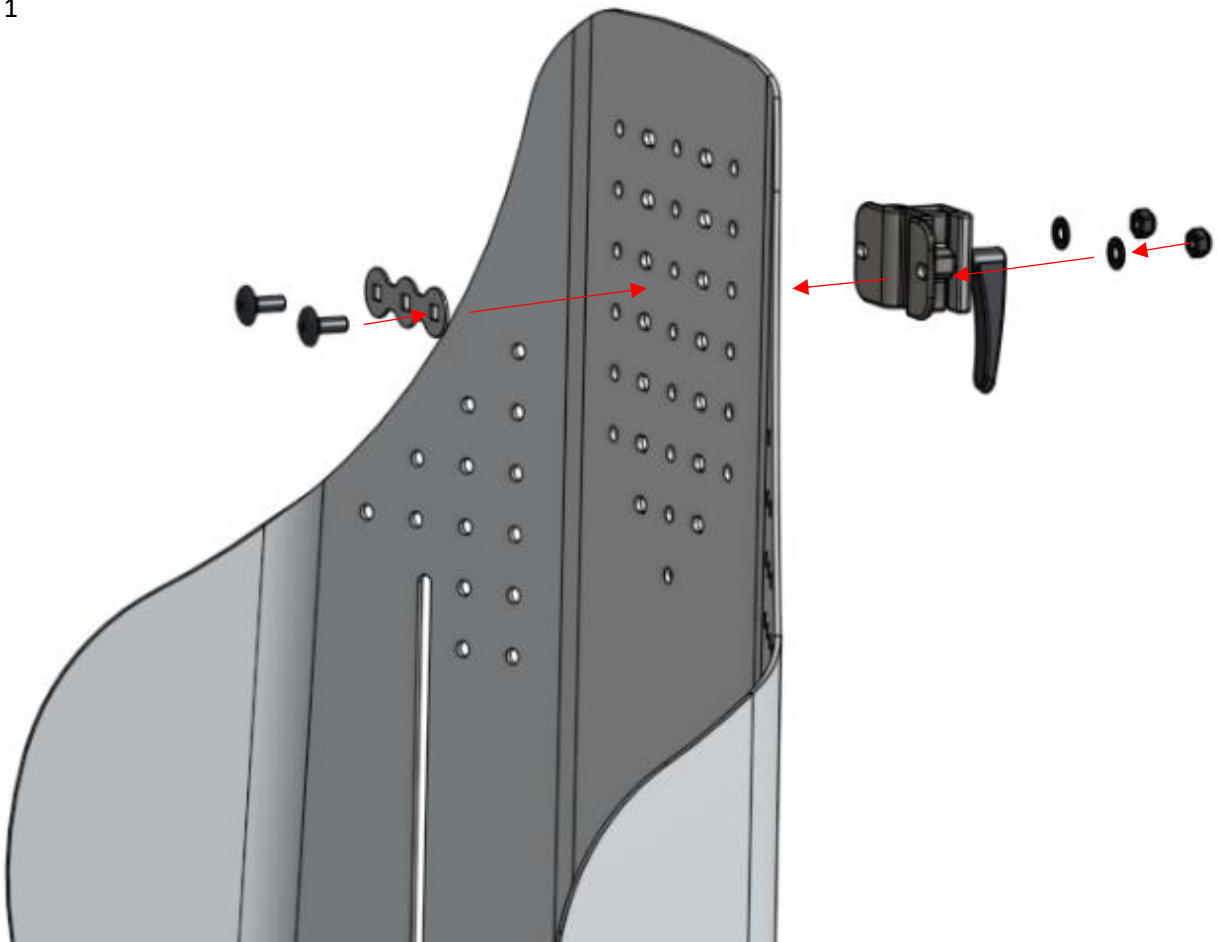

Fig 2

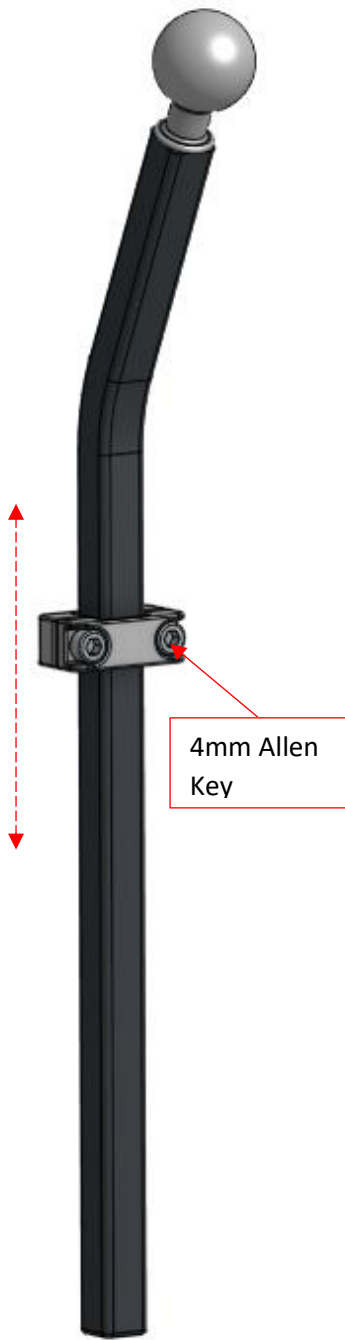

Fig 3



Fig 4

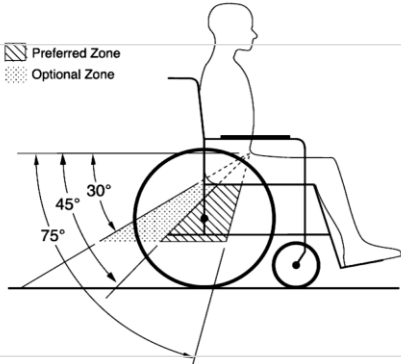

Fig 5



Fig 6

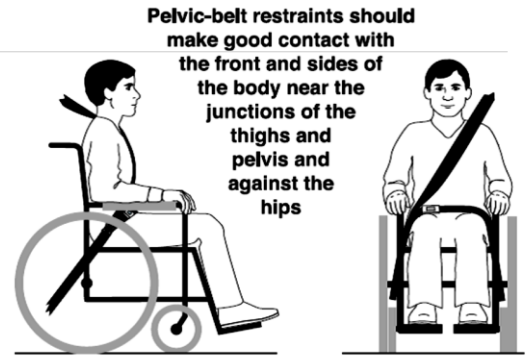
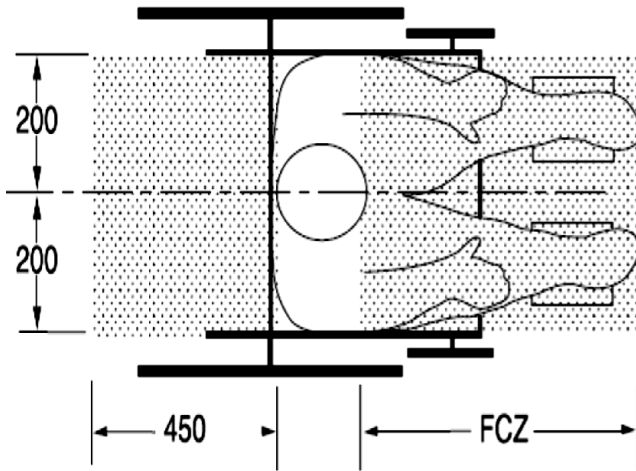

Fig 7

TOP VIEW



NOTES: The rear clear zone is measured from the rearmost point on an occupant's head. The front clear zone is measured from the frontmost point on an occupant's head.

Seated head height (HHT) ranges from about 1200 mm for a small adult female to about 1550 mm for a tall adult male.

Fig 8

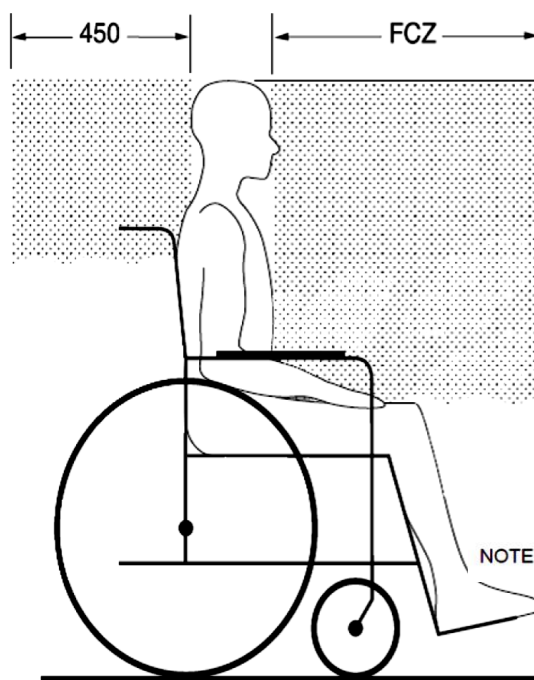

FIG.

FCZ = 650 mm with upper torso restraint  
 = 950 mm with only pelvic restraint

**NOTE: It is strongly recommended that both pelvic and upper-torso belts be used.**

**Recommended forward and rearward clear zones for wheelchair-seated occupants**

NOTE The frontal clear zone may not be achievable for wheelchair-seated drivers.

SIDE VIEW



## TRANSPORTATION WARNINGS

1. When transporting occupants on their wheelchairs inside motor vehicles, Dreamline Wheelchair Seating is designed only for use with wheelchair frames that have been successfully crash tested to the frontal-impact requirements of RESNA WC-42012, Section 19.
2. When used as a seat for the occupant inside a motor vehicle, Dreamline Wheelchair Seating must only be used on wheelchair frames that provide four securement points and pelvic belt anchor points that conform to the requirements of RESNA WC-4:2012, Section 19.
3. When the Dreamline seating system is used for occupancy inside a motor vehicle, it is designed specifically for wheelchairs that are forward facing inside the motor vehicle.
4. When the Dreamline Seating system is used for occupancy inside a motor vehicle it must only be used in accordance with the wheelchair manufacturer's instructions.
5. Back supports with adjustable recline angles should not be tilted back more than 30 degrees to the vertical during travel in vehicles unless necessary for the medical & postural needs of the occupant.
6. If the back support must be adjusted to an angle that is greater than 30 degrees to the vertical during travel in a motor vehicle, the upper shoulder belt anchor point should be adjusted rearward to maintain belt contact with the wheelchair occupant's shoulder and chest.
7. Wheelchair mounted rigid trays that are not specifically designed for use during travel in motor vehicles should be...
  - a. Removed and secured separately in the vehicle, or
  - b. Secured to the wheelchair so they will not break free in a crash and
    - i. Be positioned with a gap of at least 75mm (3") between the back edge of the tray and the wheelchair occupant's abdomen and/or chest so as not to interfere with proper belt restraint use, and
    - ii. Have energy absorbing padding placed between the back edge of the tray and the wheelchair occupant.
8. The use of a postural pelvic belt attached to the wheelchair base or seat frame is encouraged during travel, but these belts should be positioned so they don't interfere with the proper positioning of crashworthy belt restraints, and they should not be relied on for occupant protection in crash situations unless the postural belt has been designed to comply with, and perform to, the requirements of 4.6, 5.2, and 5.3 of RESNA WC-4:2012, Section 19 (i.e. with WC19).
9. People who use wheelchairs should transfer to the vehicle seat and use the vehicle installed occupant-restraint systems when this is feasible.
10. There must be sufficient clear space around the wheelchair for the wheelchair occupant and other occupants inside the vehicle to remain safe during travel. Recommendations are made in Fig 7, 8 for Head Height (HHT) and rear space of 450mm from the users back with a Frontal Clear Zone (FCZ) of 650mm with pelvic / upper torso restraint or 950mm if there is only a pelvic restraint. This may not be achievable for wheelchair seated drivers. Wheelchair seated drivers must comply with the modified vehicle's and transport approved restraint manufacturer's instructions.

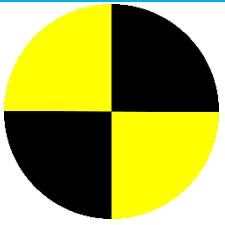

## TRANSPORTATION INSTRUCTIONS

The following components have all been tested & are both WC20 & ISO7176-19 certified for forward facing transportation with an occupant in a motor vehicle; Quick-release Seat Pan, All Dreamline Cushions, Dreamline Contour, Support, S3 & STX Backrests, Quick-release swing-down Hip guides & Armrests, Swing-down Pommel, both fixed & Swing-away laterals & Dreamline Axis Headrests.

Dreamline Wheelchair Seating fully complies with RESNA WC-4:202, Section 20 & when used with a wheelchair frame which complies with RESNA WC-4:2012, Section 19 if used as a transportation device for an occupant in a motor vehicle.

Dreamline Wheelchair Seating has been designed to accommodate the proper use of vehicle anchored belt restraints with a rating of 16 out of 16 & pass level of A+ (Excellent): a) ease of properly positioning vehicle anchored belt restraints on the wheelchair passenger & b) the degree to which proper positioning of the belt restraints can be achieved.

1. The pelvic belt transport approved restraint should be worn low across the front of the pelvis near the junctions of the pelvis and thighs.
2. The angle of the transport approved pelvic belt restraint should be between 30 degrees to 75 degrees relative to the horizontal and ideally between 45 degrees to 75 degrees to the horizontal as shown in Fig 4.
3. The transport approved belt restraint buckle of three-point belt restraints should be placed in contact with the occupant's body and away from wheelchair components & should not be routed outside of the wheelchair wheels or over the wheelchair arm supports (Fig 5,6).
4. The junction of the shoulder belt & the pelvic belt of the transport approved three-point belt restraint should be located near the hip opposite the shoulder over which the diagonal belt crosses and not near the midline of the occupant (Fig 6).
5. Upper torso transport approved belt restraints should fit directly over, and in contact with, the middle of the shoulder (Fig 6)
6. Transport approved belt restraints should be adjusted to fit as snugly as possible, consistent with user comfort.
7. Transport approved belt restraints should not be worn twisted in a manner that reduces the area of contact of the belt webbing with the occupant.

### ISO 16840-4

Dreamline Wheelchair Seating has been tested to comply with the requirements of ISO16840-4. Dreamline Wheelchair Seating will only comply if the corresponding wheelchair frame complies with the requirements of ISO7176-19. The frame must include anchorage points which comply with the requirements of ISO7176-19. Dreamline Wheelchair Seating have been designed and tested for forward facing travel in a motor vehicle. Dreamline Wheelchair seating will only comply if the corresponding wheelchair tie-down & occupant restraint system (WTORS) complies with ISO 10542-1.





## INSTALLATION & OCCUPANT SAFETY

- This headrest must only be configured by a qualified seating therapist or technician.
- Fully read the instructions before installing the headrest.
- Do not use this headrest if it has become loose, broken, not in the desired position, or not working properly.
- Always ensure the headrest is locked in place before using.
- Position the headrest close to the back of the head when the occupant is relaxed in the seat. Failure to position the headrest sufficiently close enough to the head could result in whiplash.
- Do not use if redness or pain develops in the region contacting the headrest.

### INTENDED USE

This item is intended for persons with disabilities as a head support on a wheelchair seat. If there are any questions about product installation or compatibility with the wheelchairs, ROLAPAL customer service should be consulted.

**Indication:** Partially or permanently non-ambulatory limited to a sitting position

**Contra-indication:** None

### CAUTION - RISKS IDENTIFIED

- The headrest can be positioned in many ways, take care to ensure the desired outcome is achieved for the occupant.
- Keep away from heaters and open flame – risk of fire.
- The headrest pad cover & foam inner are removable for cleaning. Do not use if these are not correctly in place behind the user.

### REPORTING OF INCIDENTS

All serious incidents occurring in relation to the product must be reported to ROLAPAL Ltd and your competent authority!

### DISCLAIMER

Because of the infinite adjustability of the headrest, Rolapal accepts no responsibility for the therapeutic outcome for the occupant. This is the responsibility of the seating therapist or technician.

### REUSABILITY

The product is basically suitable for reuse. The reuse handover takes place after the product has been checked by the specialist trade.

### SPECIAL STORAGE/HANDLING CONDITIONS

Do not store in environments above 50°. Do not store close to roofs to avoid heat. If not in use, please store in dust free environments.

## **PRODUCT LIFE EXPECTANCY**

This item is expected to last between 2 – 5 years under normal use but this can change dramatically between users depending on the length of time in use, environment & weight of the user.

## **END OF LIFE RECYCLING**

At the end of its useful life, all metal components are easily removed for recycling. Foam inner and cover are general waste disposal.

## **GUARANTEE**

Dreamline Supports are manufactured to a very high standard and carry a guarantee against defects in materials and craftsmanship for a period of 18 months.

Any item found to be defective will be repaired or replaced at the discretion of Rolapal Ltd.

Goods must be returned to Rolapal Ltd for assessment and the new repaired or replaced item will be sent free of charge.

This guarantee does not cover items which are damaged from general “wear and tear”, misuse or negligence.

## **INSTALLATION INSTRUCTIONS**

1. Attach the headrest mount assembly to the rear surface of the backrest shell. Insert the two coach bolts through the fixing plate, through the backrest shell then sit the mount over the protruding threads, slide on the two washers then tighten the nyloc nuts firmly as in Fig 1. Attach the headrest around 4” (100mm) down from the top edge of the backrest shell.
2. Attach the headrest pad to the top arm and the headrest vertical stem to the top arm, inserting the ball into the sockets and lightly tighten the six screws (Fig 3 - A) using a 4mm Allen key. Extra links (Fig 3 – C) may be added to enable more depth adjustability if required.
3. Insert the vertical headrest stem into the headrest mount and lock at the desired height by moving the height lock assembly along the stem and tighten in the desired position with a 4mm Allen key (Fig 2). This enables the headrest to be always positioned at the same height when the headrest is removed for easy client transfers.
4. Adjust the headrest pad to the desired position by repositioning the top arm assembly links with a 4mm Allen key (Fig 3 – B) then tightening all the screws to lock the bracket in position (Fig 3 – A).

## **USING THE HEADREST**

Release the lever on the headrest mount to remove the headrest then insert the vertical stem and tighten the lever to lock in place.

No on-going maintenance required.

## **CARE INSTRUCTIONS**

The outer cover is removable for washing. (Nylon / Neoprene)

- Warm machine washable
- Drip dry only.
- Do not iron.
- Do not use strong chemicals or bleach.

# Dreamline

WHEELCHAIR SEATING

*Posture adaptive*

*Pressure reactive*

*Performance effective*



**Ignite**

**SPLASH**

**Dreamline**

WHEELCHAIR SEATING



**Woven Air**

**snooza**



***Quality Assurance***

*Rolapal Ltd is an ISO 9001, 14001 & 45001 certified company!*

# Dreamline

## WHEELCHAIR SEATING

by

# ROLAPAL



Dr Dreamline

Check out our "How to"  
Videos Pages

Manufactured By:



**ROLAPAL Ltd**

14 Marphona Crescent, Takanini 2105 Auckland, New Zealand

Email: [info@rolapal.co.nz](mailto:info@rolapal.co.nz)

Website: [www.rolapal.co.nz](http://www.rolapal.co.nz)

EC

REP

BEO MedConsulting Berlin GmbH

Helmholtzstraße 2–9, D-10587 Berlin

